

P.C.B LAYOUT MOUNTING PATTERN

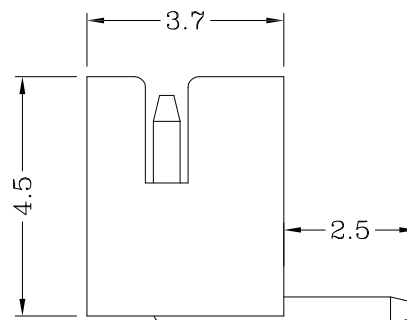
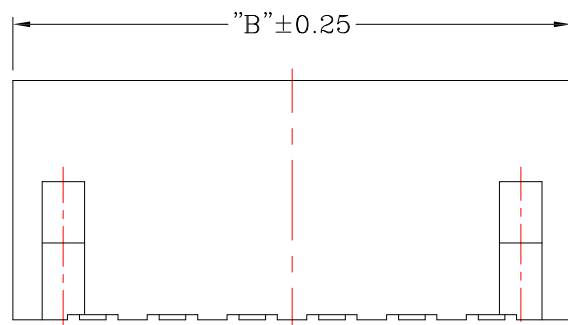

SPECIFICATIONS

- 1.Current rating : 1.0A
- 2.Voltage rating : 50V, AC / DC
- 3.Temperature rating : -25°C ~ +85°C
- 4.Insulation resistance : 1000MΩ min.
- 5.Contact resistance : 20mΩ /Max
- 6.Withstand Voltage : 500V AC / minute

Material:

- 1.Housing : PA46
- 2.Contact : Brass,Tin over Nickel

	2	3	4	5	6	7	8	9	10	11	12	13	14	15	16
DIM.A	1.50	3.00	4.50	6.00	7.50	9.00	10.50	12.00	13.50	15.00	16.50	18.00	19.50	21.00	22.50
DIM.B	4.50	6.00	7.50	9.00	10.50	12.00	13.50	15.00	16.50	18.00	19.50	21.00	22.50	24.00	25.50

CONTACT 建倚科技股份有限公司
CONTACT TECHNOLOGY CORP.

TOLERANCE UNLESS OTHERWISE STATED :
Up to 5 ±0.2
Above 5 ~ 15 ±0.3
Above 15 ~ 30 ±0.4
Above 30 ~ 50 ±0.5
Angle ±0.3

3RD. ANGEL'S



UNITS MM

DRAWN BY: Jack Lu DATE: 05/17/19
CHECKED BY: Jacky Chen DATE: 05/17/19
APPROVED BY: Tony Kao DATE: 05/17/19

MATL		TITLE	CONNECTOR
FINISH		MODLE	WAFER 1.5 PIN 90度
SCALE	1 : 1	DWG NO.	WF-1500RDxx-S304
SHEET NO.	1 of 1	PART NO.	WF-1500RDxx-S304
		SIZE	A4
		VER	R

ITEM NO.	DESCRIPTION	DRAWN	DATE