

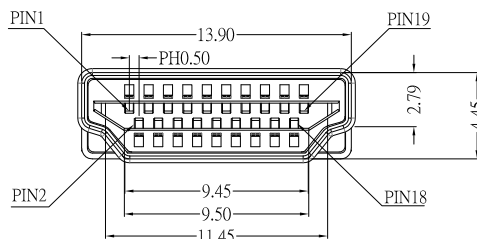

HDMI-19APL3xx-S165

外殼材質:	Blank : BRASS I : SPCC	外殼電鍍材質:	G : Au NI : Nickel
-------	---------------------------	---------	-----------------------

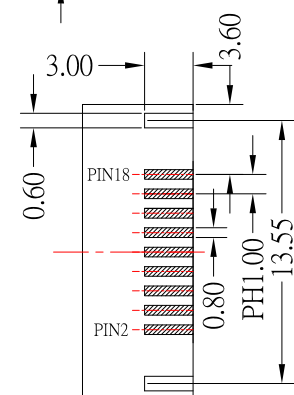
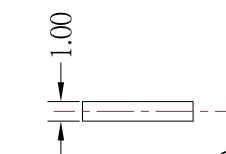
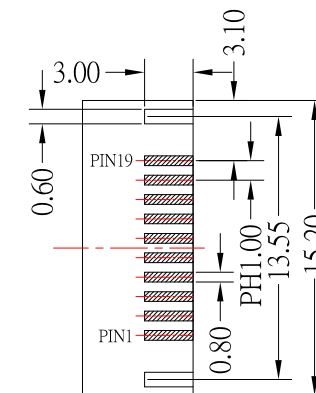
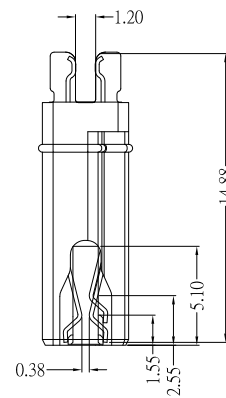
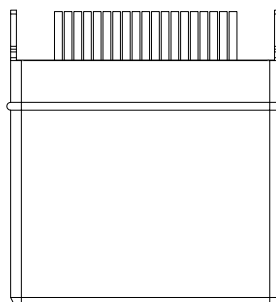
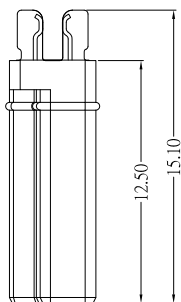
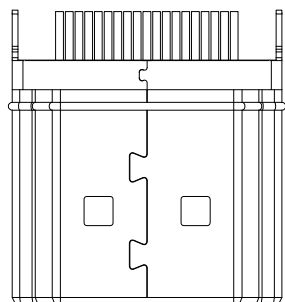
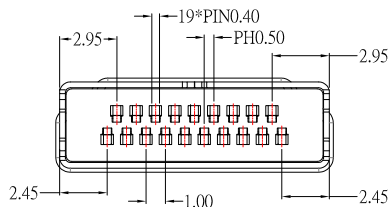

NOTE :

1.SPECIFICATION:

- 1.1 CURRENT RATING: 0.5 Amp Max.
- 1.2 VOLTAGE RATING: 40 V ac(r.m.s) Max.
- 1.3 CONTACT RESISTANCE: 10mΩ Max.
- 1.4 NSULATION RESISTANCE:100MΩ Min.
- 1.5 DIELECTRIC WITHSTANDING VOLTAGE:
AC 500V Min. (for 1 minute)
- 1.6 OPERATION TEMPERATURE RANGE: -25°C~85°C

2.MECHANICAL

- 2.1 INSERTION FORCE: 4.5KGF MAXMUM
- 2.1 WITHDRAWAL FORCE: 1.0KGF MINIMUM;4.0KGF MAXMUM

3.Material:

- 3.1 Housing: LCP
- 3.2 Contact: BRASS
- 3.3 Shell: BRASS / SPCC

4. Finish:

- 4.1 Contact: Plated Gold in Mating Area ;
Gold Plated on Solder Balls ;
Nickel under plated overall
- 4.2 Shell: Nickel / Gold under Plated surface layer

CONTACT 建倚科技股份有限公司
CONTACT TECHNOLOGY CORP.

TOLERANCE UNLESS OTHERWISE STATED :

Up to 5 ±0.2
Above 5 ~ 15 ±0.3
Above 15 ~ 30 ±0.4
Above 30 ~ 50 ±0.5
Angle ±0.3°

3RD. ANGEL'S



UNITS MM

DRAWN BY:	DATE
Jack Lu	02/25/15
CHECKED BY:	DATE
Jacky Chen	02/25/15
APPROVED BY:	DATE
Tony Kao	02/25/15

MAT'L	TITLE	CONNECTOR
FINISH	MODLE	HDMI A TYPE 夾板公頭 H:1.2mm
SCALE	DWG NO.	HDMI-19APL3xx-S165
SHEET NO.	PART NO.	HDMI-19APL3xx-S165
1 of 1	SIZE	A4
	VER	R3

ITEM NO.	DESCRIPTION	DRAWN	DATE
3	更新夾板尺寸	Jack	022515
2	更新鍍層代號及更新pcb layout尺寸	Jack	112714
1	更新鍍層代號	Jack	111214