

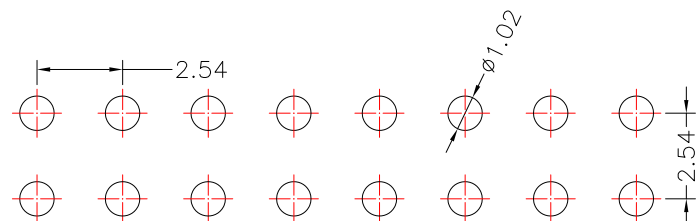

FH-A12-02xxx-S304

PIN數

| | | | |
|---|-----|-----|-----|
| | L1 | L2 | L3 |
| A | 8.5 | 1.2 | 3.1 |

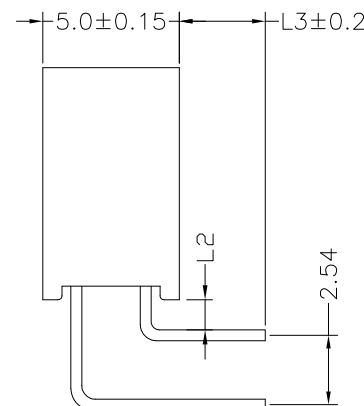
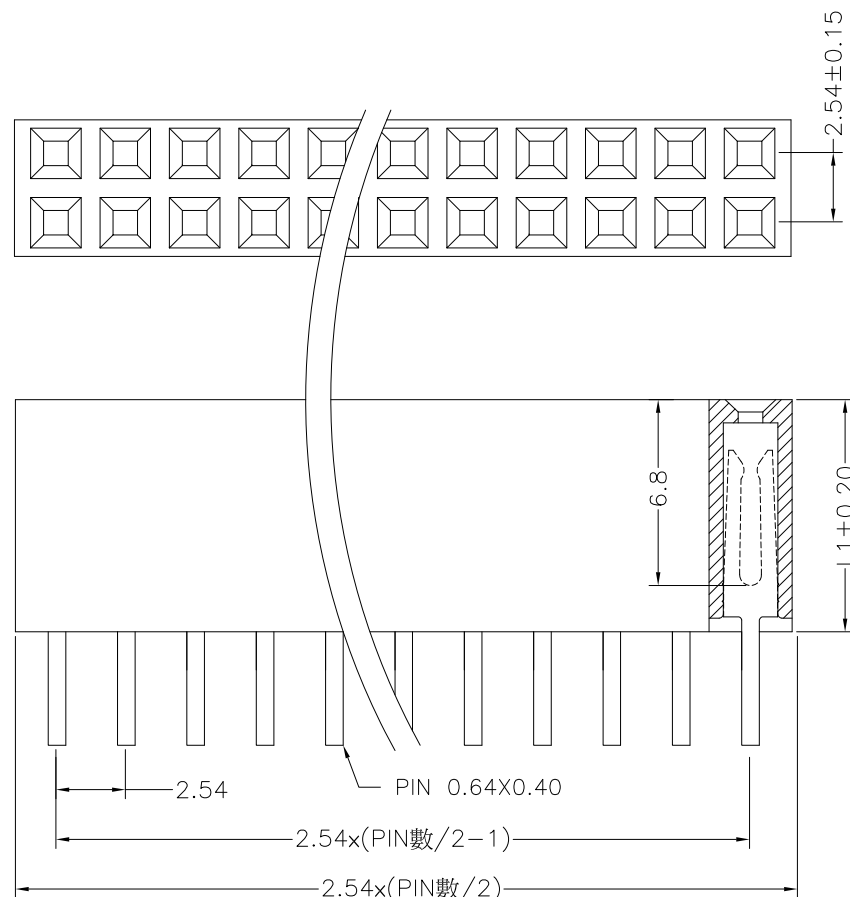

P.C.B. LAYOUT

SPECIFICATIONS:

- 1.Current Rating : 3.0 AMP
- 2.Insulation Resistance : 1000MΩ Min
- 3.Dielectric Withstanding : 1000V AC
- 4.Contact Resistance : 20mΩ Max
- 5.Operation Temperature : -40°C to +105°C

MATERIALS:

- 1.Contact : Phosphor Bronze
- 2.Insulator : PBT ,UL94V-0
- 3.Contact Finish : Gold over Nickel

| | | | | | | | | | | | | | |
|--|--|--|--|-------------------------------------|--|------------------------|--|--------------------|--|----------------------------|--|-----------------------|--|
| | | | | | | DRAWN BY: Jack Lu | | DATE: 08/07/17 | | MAT'L | | TITLE: Female Header | |
| | | | | | | CHECKED BY: Jacky Chen | | DATE: 08/07/17 | | FINISH | | MODLE: 2.54 排母 雙排 R/A | |
| | | | | TOLERANCE UNLESS OTHERWISE STATED : | | 3RD. ANGEL'S | | UNITS | | MM | | SCALE: 1 : 1 | |
| | | | | Up to 5 ±0.2 | | Above 5 ~ 15 ±0.3 | | Above 15 ~ 30 ±0.4 | | Above 30 ~ 50 ±0.5 | | Angle ±0.3 | |
| | | | | APPROVED BY: Tony Kao | | DATE: 08/07/17 | | SHEET NO. 1 of 1 | | PART NO. FH-A12-02xxx-S304 | | SIZE: A4 | |
| | | | | | | | | | | | | VER: R | |