

P.C.B LAYOUT

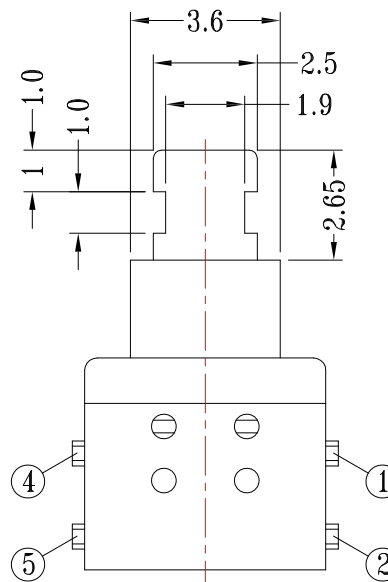
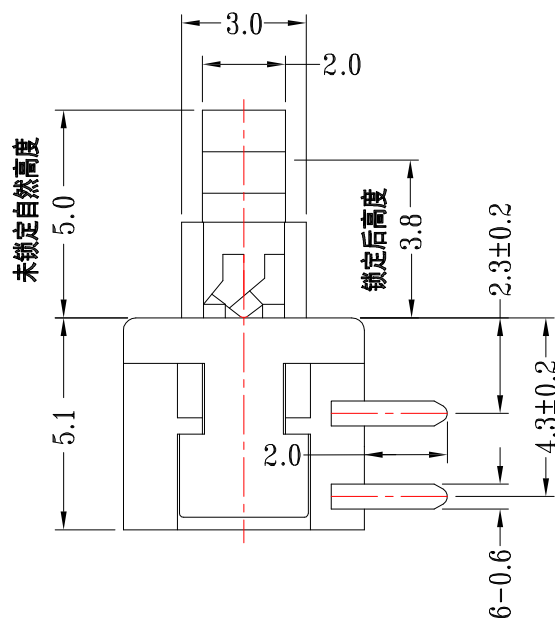

SPECIFICATIONS:

- 1.RATING: 30V DC , 100mA
- 2.CONTACT RESISTANCE: 200mΩ Max
- 3.INSULATION RESISTANCE: 100MΩ Min
- 4.OPERATING FORCE: 250±50 gf
- 5.OPERATING LIFE:10,000 Cycles

NO.	DESCRIPTION	QTY	MATERIAL	PLATING
7	TERMINAL	4	PHOSPHOR BRONZE	Ag plated
6	CONTACT	1	BRASS	Ag plated
5	SPRING	1	SUS	
4	CAM STICK	1	SUS	
3	CASE	1	PPA(Black)	
2	COVER	1	PPA(Grey)	
1	KNOB	1	PPA(White)	

CONTACT 建倚科技股份有限公司
CONTACT TECHNOLOGY CORP.

TOLERANCE UNLESS OTHERWISE STATED :
 Up to 5 ±0.2
 Above 5 ~ 15 ±0.3
 Above 15 ~ 30 ±0.4
 Above 30 ~ 50 ±0.5
 Angle ±0.3

3RD. ANGEL'S



UNITS MM

DRAWN BY: Jack Lu
 CHECKED BY: Jacky Chen
 APPROVED BY: Tony Kao

DATE: 04/07/25
 DATE: 04/07/25
 DATE: 04/07/25

MAT'L	TITLE	SWITCH
FINISH	MODLE	PUSH SWITCH
SCALE: 1 : 1	DWG NO.	PS-22E58L-S313
SHEET NO. 1 of 1	PART NO.	PS-22E58L-S313

SIZE: A4
 VER: R