

BC-A33FC-xx-S410

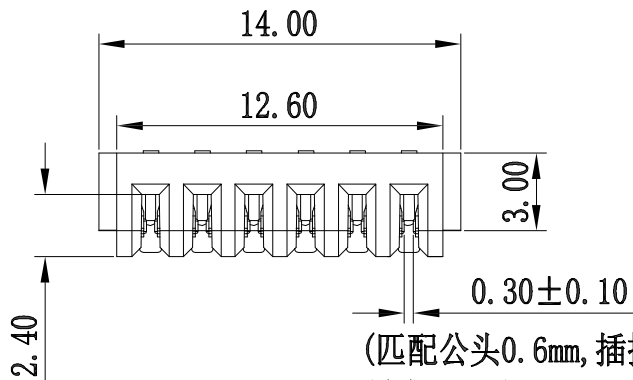

(匹配公头0.6mm, 插拔3000次后  
最大开口小于0.45mm)

P/N:	dim.A	dim.B	dim.C	dim.D
03	8.00	6.60	4.00	7.40
04	10.00	8.60	6.00	9.40
05	12.00	10.60	8.00	11.40
06	14.00	12.60	10.00	13.40
07	16.00	14.60	12.00	15.40
08	18.00	16.60	14.00	17.40
09	20.00	18.60	16.00	19.40
10	22.00	20.60	18.00	21.40
11	24.00	22.60	20.00	23.40
12	26.00	24.60	22.00	25.40

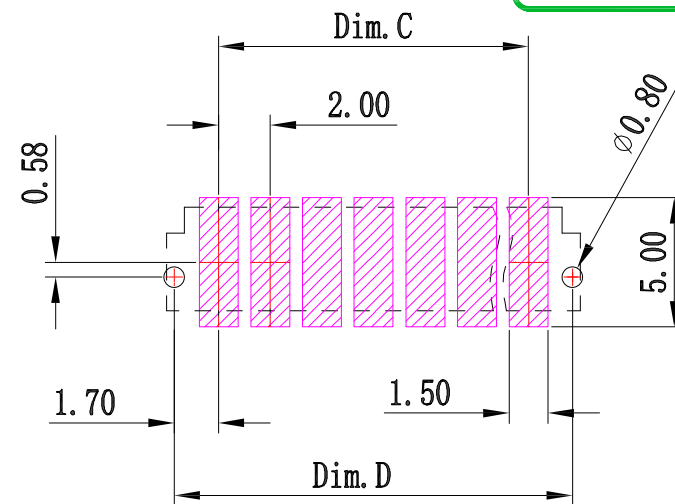

P.C.B LAYOUT

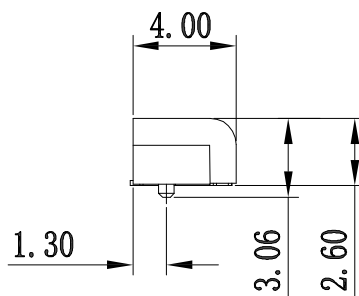
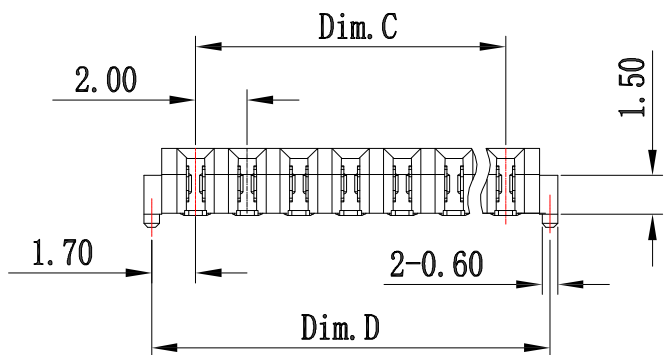

MATERIAL

INSULATOR : LCP

CONTACT : C5191

CONTACT PLATED : GOLD OVER NICKEL OR TIN  
SPECIFICATION

VOLTAGERATING: 30VDC

CURRENT RATING : 7A/Pin

INSTANT CURRENT : 10A/Pin

CONTACT RESISTANCE : 20mΩ

INSULATION RESISTANCE : 100 MΩ Min.

DIELECTRIC VOLTAGE : 500V

OPERATING TEMPERATURE : -40° C~105° C

**CONTACT** 建倚科技股份有限公司  
CONTACT TECHNOLOGY CORP.

TOLERANCE UNLESS OTHERWISE STATED :  
Up to 5 ±0.2  
Above 5 ~ 15 ±0.3  
Above 15 ~ 30 ±0.4  
Above 30 ~ 50 ±0.5  
Angle ±0.3

3RD. ANGEL'S

UNITS MM

DRAWN BY:	DATE	MATL	TITLE	CONNECTOR
Jack Lu	02/12/25			
CHECKED BY:	DATE	FINISH	MODLE	2.0mm BATTERY CONNECTOR FEMALE
Jacky Chen	02/12/25			
APPROVED BY:	DATE	SCALE	DWG NO.	BC-A33FC-xx-S410
Tony Kao	02/12/25	1 : 1		
SHEET NO.	1 of 1	PART NO.	BC-A33FC-xx-S410	
				SIZE A4
				VER R