

SBC-WP060S2-20x-S331

鍍層厚度:

Blank : 1u"
2 : 15u"
3 : 30u"

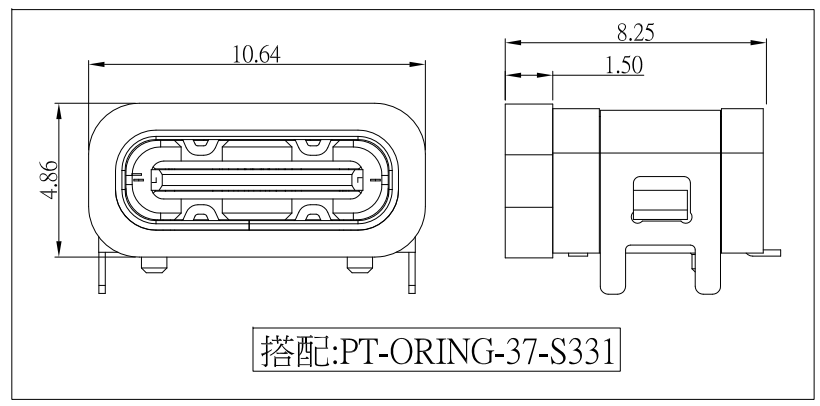
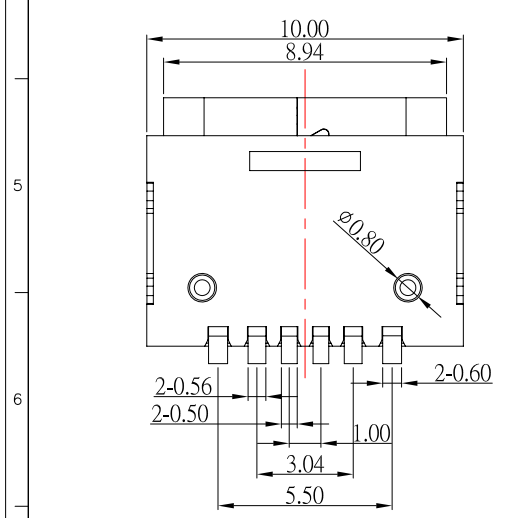

搭配:PT-ORING-37-S331

P.C.B LAYOUT MOUNTING PATTERN

SPECIFICATIONS

Electrical:

- Rating: 5.0V , 3.0A
- Contact Resistance: 40 mΩ Max
- Insulation Resistance: 100 MΩ Min
- Dielectric Withstanding Voltage: 100V AC

Mechanical:

- Connector Mate and Unmate Force
 - Mate force: 5~20 N
 - Unmate force: 8~20 N

Material:

- Housing: LCP
- Contact: C7025
- Shell: SUS

Finish:

- Contact: Plated Gold in Mating Area ;
Tin Plated on Solder Balls ;
Nickel under plated overall
- Shell: Nickel under Plated surface layer

ITEM NO.	DESCRIPTION	DRAWN	DATE
3	更新圖面	Jack	082123
2	更新圖面	Jack	021323
1	更新圖面	Jack	063022

CONTACT 建倚科技股份有限公司
CONTACT TECHNOLOGY CORP.

TOLERANCE UNLESS OTHERWISE STATED:

Up to 5	±0.2
Above 5 ~ 15	±0.3
Above 15 ~ 30	±0.4
Above 30 ~ 50	±0.5
Angle	±0.3°

3RD. ANGEL'S

UNITS: MM

DRAWN BY:	DATE	MAT'L	TITLE	CONNECTOR
Jack Lu	08/21/23			
CHECKED BY:	DATE	FINISH	MODLE	USB C TYPE 2.0 Female 防水型
Jacky Chen	08/21/23			
APPROVED BY:	DATE	SCALE	DWG NO.	SBC-WP060S2-20x-S331
Tony Kao	08/21/23	1 : 1		
		SHEET NO.	PART NO.	SBC-WP060S2-20x-S331
		1 of 1		
			SIZE	A4
			VER	R3