

P.C.B LAYOUT

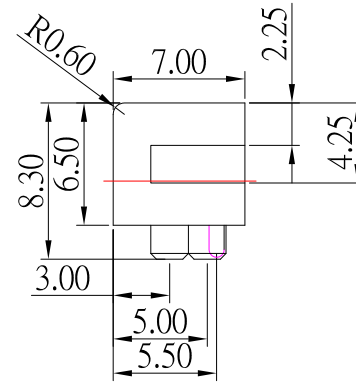

No. of Pins	Dimension			
	DIM.A	DIM.B	DIM.C	DIM.D
03	17.85	4.00	15.00	9.00
04	19.85	6.00	17.00	11.00
05	21.85	8.00	19.00	13.00
06	23.85	10.00	21.00	15.00
07	25.85	12.00	23.00	17.00
08	27.85	14.00	25.00	19.00
09	29.85	16.00	27.00	21.00
10	31.85	18.00	29.00	23.00
11	33.85	20.00	31.00	25.00
12	35.85	22.00	33.00	27.00

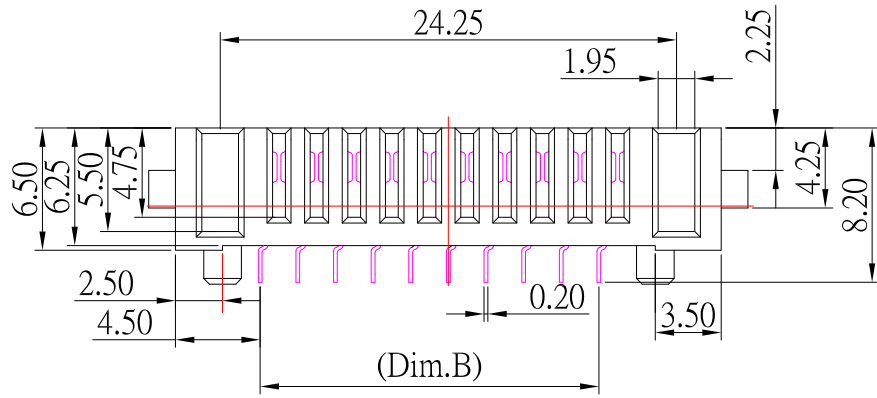
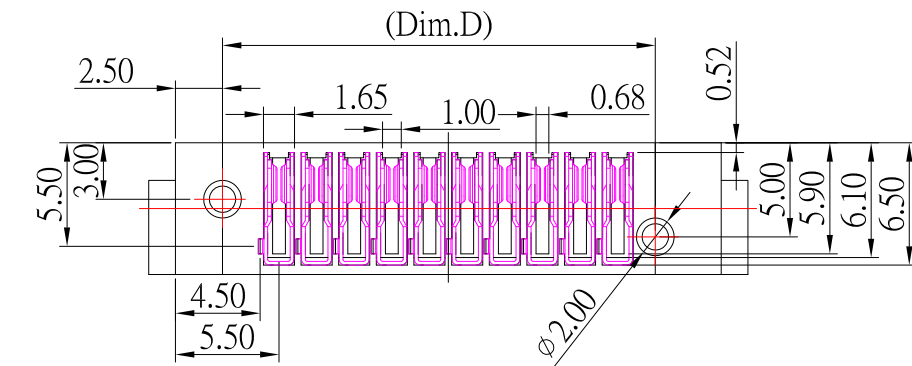

Material  
 Insulator : PA9T Contact : Phosphor Bronze  
 Contact Plated : Gold over Nickel or Tin  
 Specification  
 Current Rating : 5.0A  
 Instant Current : 7.0A  
 Contact Resistance : 30mΩ  
 Insulation Resistance : 100MΩ  
 Dielectric Voltage : 500V  
 Operating Temperature : -40°~105°

**CONTACT** 建倚科技股份有限公司  
**CONTACT TECHNOLOGY CORP.**

TOLERANCE UNLESS OTHERWISE STATED :  
 Up to 5 ±0.2  
 Above 5 ~ 15 ±0.3  
 Above 15 ~ 30 ±0.4  
 Above 30 ~ 50 ±0.5  
 Angle ±0.3°

3RD. ANGEL'S

UNITS MM

DRAWN BY:	DATE	MAT'L	TITLE	CONNECTOR
Jack Lu	09/21/23			
CHECKED BY:	DATE	FINISH	MODLE	Battery 直立式 母座
Jacky Chen	09/21/23			
APPROVED BY:	DATE	SCALE	DWG NO.	BC-FVA01-xP-S410
Tony Kao	09/21/23	1 : 1	PART NO.	BC-FVA01-xP-S410
		SHEET NO.	1 of 1	
				SIZE A4
				VER
				R

ITEM NO.	DESCRIPTION	DRAWN	DATE