

# SBC-WP160VS6-20x-S410

鍍層厚度:  
Blank : 1u"  
2 : 15u"  
3 : 30u"

USB TYPE-C FULL-FEATURED RECEPTACLE INTERFACE PIN ASSIGNMENTS

PIN Name	Signal Name	Description	PIN Name	Signal Name	Description
A1	DND	Ground return	B12	DND	Ground return
A4	Vbus	Bus Power	B9	Vbus	Bus Power
A5	CC1	Configuration Channel	B8	SRx2	Sideband Use(SRx)
A6	Dp1	Positive half of the USB 2.0 differential pair(Position 1)	B7	Dm2	Negative half of the USB 2.0 differential pair(Position 2)
A7	Dn1	Negative half of the USB 2.0 differential pair(Position 1)	B6	Dp2	Positive half of the USB 2.0 differential pair(Position 2)
A8	SRx1	Sideband Use(SRx)	B5	CC2	Configuration Channel
A9	Vbus	Bus Power	B4	Vbus	Bus Power
A12	DND	Ground return	B1	DND	Ground return

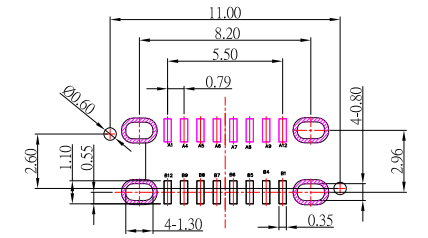

RECOMMENDED PCB LAYOUT

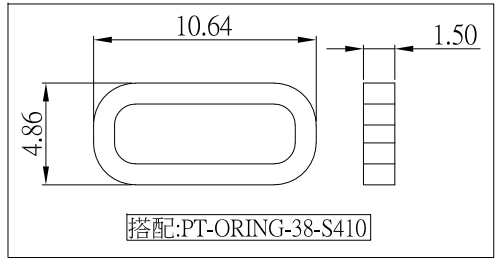
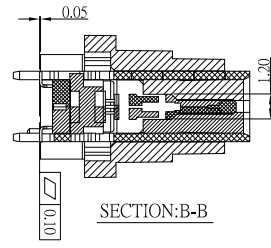
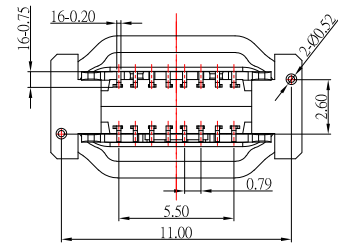
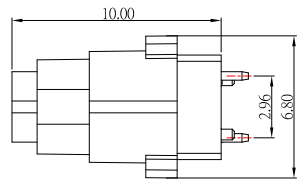
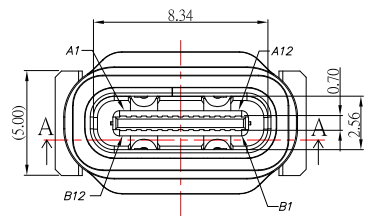

## SPECIFICATIONS

### Electrical:

- Rating: 5.0 A
- Contact Resistance: 40 mΩ Max
- Insulation Resistance: 100 MΩ Min

### Mechanical:

- Connector Mate and Unmate Force
  - Mate force: 5~20 N
  - Unmate force: 8~20 N

### Material:

- Housing: LCP
- Contact: C7025
- Shell: SUS

### Finish:

- Contact: Plated Gold in Mating Area ;  
Tin Plated on Solder Balls ;  
Nickel under plated overall
- Shell: Nickel under Plated surface layer

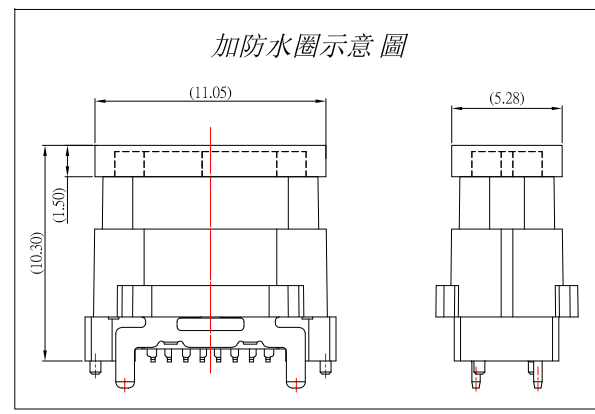
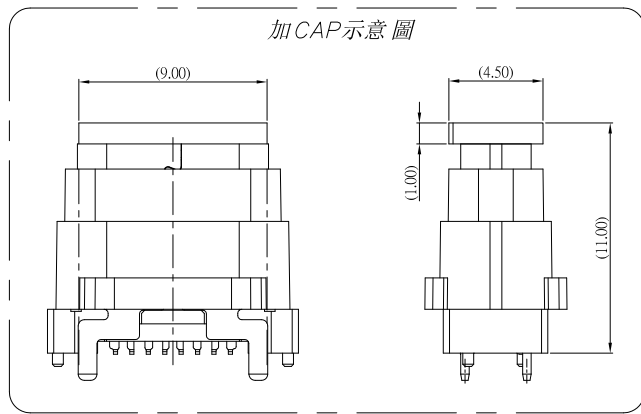
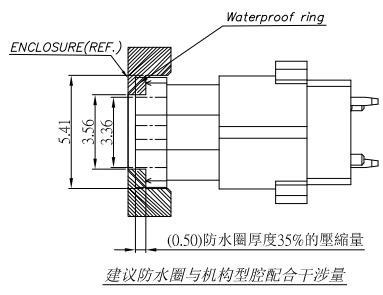
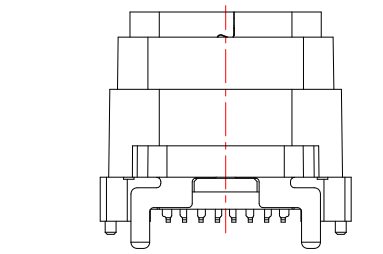

1	更新圖面	Jack	011326
ITEM NO.	DESCRIPTION	DRAWN	DATE

**CONTACT** 建倚科技股份有限公司  
CONTACT TECHNOLOGY CORP.

TOLERANCE UNLESS OTHERWISE STATED :	Up to 5 ±0.2 Above 5 ~ 15 ±0.3 Above 15 ~ 30 ±0.4 Above 30 ~ 50 ±0.5	3RD. ANGEL'S	UNITS	MM
-------------------------------------	---	--------------	-------	----

DRAWN BY:	DATE	MAT'L	TITLE	CONNECTOR
Jack Lu	01/13/26	FINISH	MODLE	USB C TYPE 180 度 SMT 2.0 Female H10.0防水型
CHECKED BY:	DATE	SCALE	DWG NO.	SBC-WP160VS6-20x-S410
Jacky Chen	01/13/26	1 : 1	PART NO.	SBC-WP160VS6-20x-S410
APPROVED BY:	DATE	SHEET NO.	1 of 2	
Tony Kao	01/13/26			