

P. C. B LAYOUT  
TOP VIEW

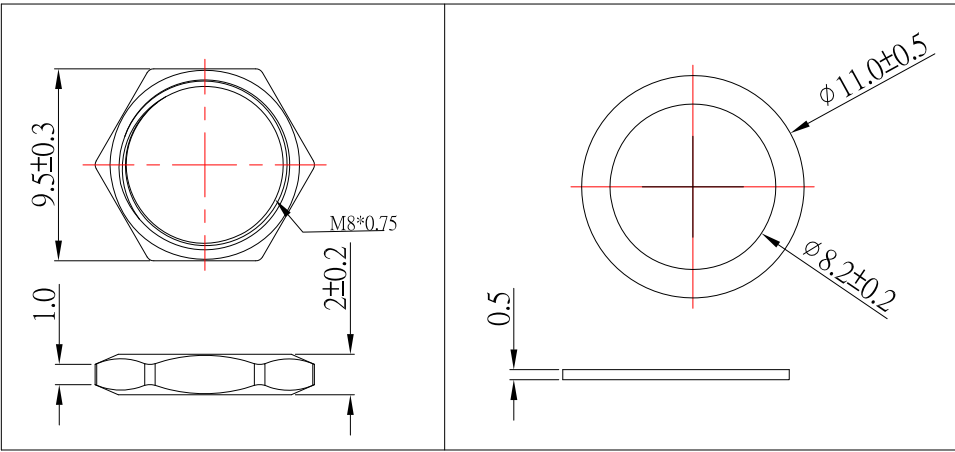

MODEL NO.	DC-D125M-x
SCHEMATIC	
CENTER PIN	$\phi 2.0\text{mm}$
	$\phi 2.5\text{mm}$

**SPECIFICATION**

- Rating : DC 30V, 5.0A
- Contact resistance :  $\leq 30\text{m}\Omega$
- Insulation resistance :  $\geq 100\text{M}\Omega$
- Withstand voltage : 500VAC
- Insertion and extraction force : 3-20N
- life test : 5,000 cycles

NO.	DESCRIPTION	QTY	MATERIAL	PLATING
8	SPLIT WASHER	1	IRON	Ni-Plating
7	NUT	1	BRASS	Ni-Plating
6	HOUSING	1	PBT	
5	AXIS SUPPORT	1	BRASS	Ni-Plating
4	PIN	1	BRASS	Ni-Plating
3	FLAT PIECE	1	BRASS	Sn-Plating
2	CURVE PIECE	1	BRASS	Sn-Plating
1	SPRING	1	PHOSPHOR BRONZE	Sn-Plating

ITEM NO.	DESCRIPTION	DRAWN	DATE
5	更新華司尺寸及PCB LAYOUT樣式	Jack	021722
4	更新華司樣式	Jack	102821
3	新增尺寸及更新尺寸	Jack	102021
2	更新圖面	Jack	080320
1	更新PCB LAYOUT尺寸	Jack	122719

**CONTACT** 建倚科技股份有限公司  
CONTACT TECHNOLOGY CORP.

TOLERANCE UNLESS OTHERWISE STATED

Up to 5	$\pm 0.2$
Above 5 ~ 15	$\pm 0.3$
Above 15 ~ 30	$\pm 0.4$
Above 30 ~ 50	$\pm 0.5$
Angle	$\pm 0.3^\circ$

3RD. ANGEL'S

UNITS: MM

DRAWN BY:	DATE	MAT'L	TITLE	JACK
Jack Lu	02/17/22			
CHECKED BY:	DATE	FINISH	MODLE	DC JACK
Jacky Chen	02/17/22			
APPROVED BY:	DATE	SCALE	DWG NO.	DC-D125M-x-S124
Tony Kao	02/17/22	1 : 1		
		SHEET NO.	PART NO.	DC-D125M-x-S124
		1 of 1		