

RECOMMEND PCB LAYOUT

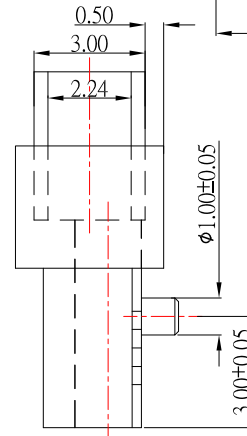
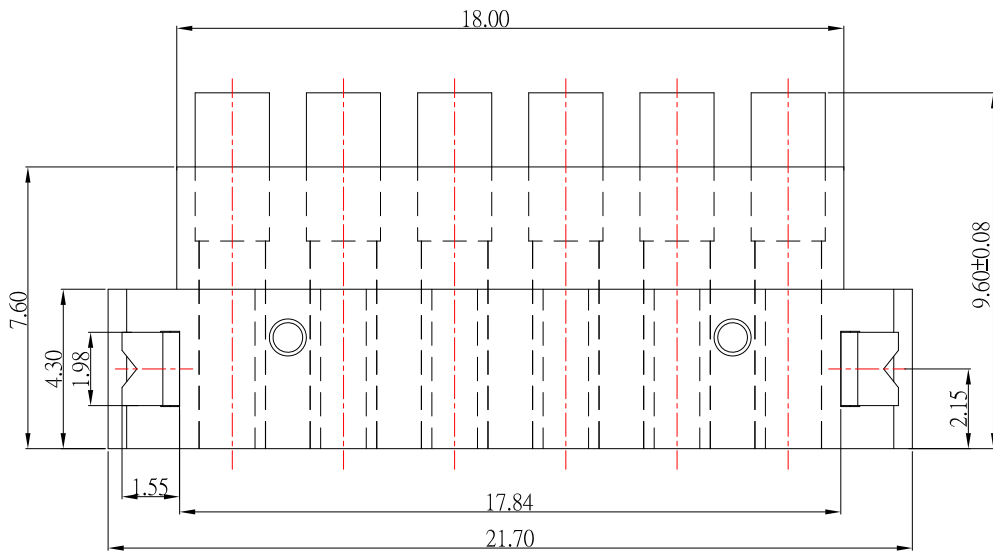

NOTE

1. Material
Brass
2. Plating
Au over NI
3. Electrical
Rated current & voltage: DC 12V; 1.0A Max.
4. To ensure the best usage, please operate it based on the working height. Based on the engineering drawings, shall not exceed the maximum allowed compression.
5. To avoid arcing issue, The adaptor start to power supply after connector mated fully.

| | | | |
|----------|-------------|-------|--------|
| 2 | 新增尺寸 | Jack | 122817 |
| 1 | 更新圖面 | Jack | 122717 |
| ITEM NO. | DESCRIPTION | DRAWN | DATE |

CONTACT 建倚科技股份有限公司
CONTACT TECHNOLOGY CORP.

TOLERANCE UNLESS OTHERWISE STATED:
 Up to 5 ±0.2
 Above 5 ~ 15 ±0.3
 Above 15 ~ 30 ±0.4
 Above 30 ~ 50 ±0.5
 Angle ±0.3°

3RD. ANGEL'S

UNITS MM

| | | | | |
|--------------|----------|-----------|----------|------------------|
| DRAWN BY: | DATE | MAT'L | TITLE | CONNECTOR |
| Jack Lu | 12/28/17 | | | |
| CHECKED BY: | DATE | FINISH | MODLE | POGO PIN |
| Jacky Chen | 12/28/17 | | | |
| APPROVED BY: | DATE | SCALE | DWG NO. | PGC-3096-6P-S353 |
| Tony Kao | 12/28/17 | 1 : 1 | PART NO. | PGC-3096-6P-S353 |
| | | SHEET NO. | 1 of 1 | |
| | | | | SIZE A4 |
| | | | | VER R2 |