

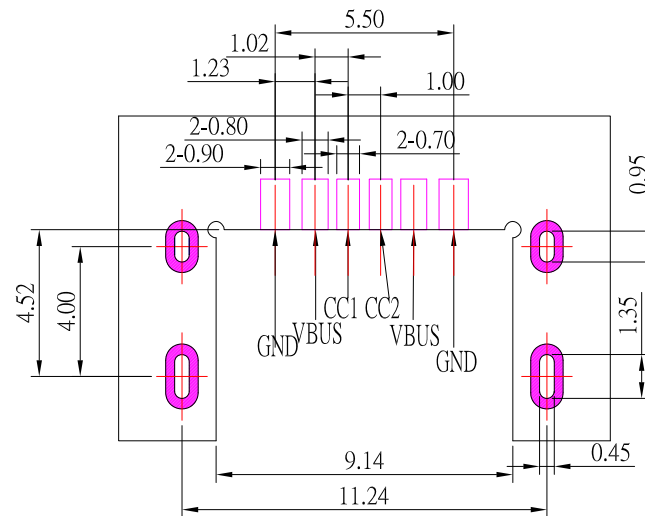

# SBC-060M4-20x-S412

鍍層厚度:

Blank : 1u"
2 : 15u"
3 : 30u"

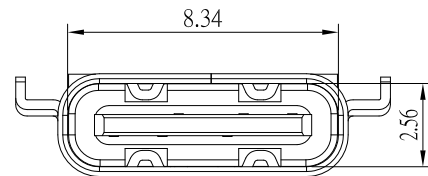

RECOMMENDED P.C.B. LAYOUT

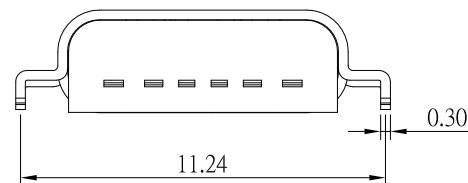
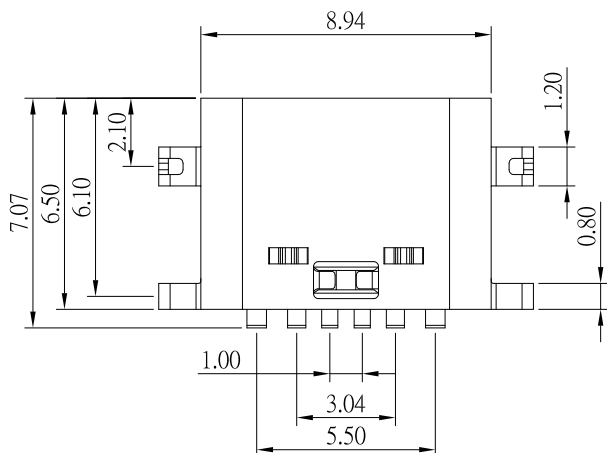
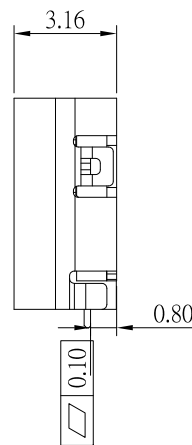
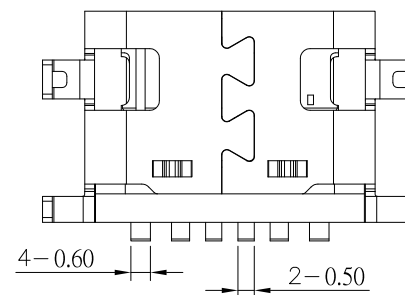

## SPECIFICATIONS

### Electrical:

- Rating: 20 V, 5.0 A for VBUS , 1.25A for GND  
0.25A for other
- Dielectric Withstand Voltage: 100V AC
- Contact Resistance: 40 mΩ Max
- Insulation Resistance: 100 MΩ Min

### Mechanical:

- Connector Mate and Unmate Force
  - Mate force: 5~20 N
  - Unmate force: 8~20 N

### Material:

- Housing: LCP
- Contact: COPPER ALLOY
- Shell: SUS

### Finish:

- Contact: Plated Gold in Mating Area ;  
Tin Plated on Solder Balls ;  
Nickel under plated overall
- Shell: Nickel under Plated surface layer

B12	GND
B9	VBUS
B5	CC2
A5	CC1
A9	VBUS
A12	GND
PIN	SIGNAL NAME

**CONTACT** 建倚科技股份有限公司  
CONTACT TECHNOLOGY CORP.

TOLERANCE UNLESS OTHERWISE STATED:  
 Up to 5 ±0.2  
 Above 5 ~ 15 ±0.3  
 Above 15 ~ 30 ±0.4  
 Above 30 ~ 50 ±0.5  
 Angle ±0.3°

3RD. ANGEL'S

UNITS MM

DRAWN BY:	DATE	MAT'L	TITLE	CONNECTOR
Jack Lu	10/14/19		MODLE	USB C TYPE 2.0 Female SMT 6PIN 沉板
CHECKED BY:	DATE	FINISH	DWG NO.	SBC-060M4-20x-S412
Jacky Chen	10/14/19	SCALE 1 : 1	PART NO.	SBC-060M4-20x-S412
APPROVED BY:	DATE	SHEET NO.	1 of 1	
Tony Kao	10/14/19			

ITEM NO.	DESCRIPTION	DRAWN	DATE