

PCB LAYOUT MOUNTING PATTERN

SPECIFICATION

- 1. Rating : DC 20V, 5.5A
- 2. Contact resistance : ≤ 30mΩ
- 3. Insulation resistance : ≥ 100MΩ
- 4. Withstand voltage : 500VAC
- 5. Insertion and extraction force : 3-30N
- 6. Life test : 5,000 cycles

MODEL NO.	DC-D3200-X
SCHEMATIC	
CENTER PIN	ø2.00mm ø2.50mm

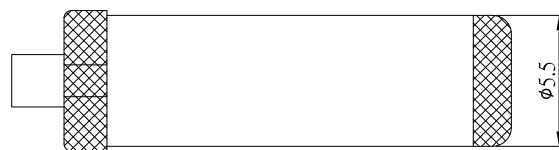

NO.	DESCRIPTION	QTY	MATERIAL	COLOR	REMARK
6	SPRING PIECE	1	SUS301	—	—
5	COAT	1	IRON	—	Ni-Plating
4	PIN	1	ZINC ALLOY	—	Ni-Plating
3	CONTACT FOOT	1	BRASS	—	Ag-Plating
2	SPRING PIECE	1	PHOSPHOR BRONZE	—	Ag-Plating
1	HOUSING	1	PA9T	—	—

ITEM NO.	DESCRIPTION	DRAWN	DATE
4	更新CENTER PIN選項	Jack	042418
3	新增尺寸	Jack	070717
2	更新為A0版	Jack	112416
1	新增尺寸	Jack	111716

CONTACT 建倚科技股份有限公司
CONTACT TECHNOLOGY CORP.

TOLERANCE UNLESS OTHERWISE STATED:
 Up to 5 ±0.2
 Above 5 ~ 15 ±0.3
 Above 15 ~ 30 ±0.4
 Above 30 ~ 50 ±0.5
 Angle ±0.3°

3RD. ANGEL'S

UNITS MM

DRAWN BY:	DATE	MAT'L	TITLE	JACK
Jack Lu	04/24/18		MODLE	DC JCAK
CHECKED BY:	DATE	FINISH	SCALE	1 : 1
Jacky Chen	04/24/18		DWG NO.	DC-D3200-x-S124
APPROVED BY:	DATE	SHEET NO.	PART NO.	DC-D3200-x-S124
Tony Kao	04/24/18	1 of 1		

SIZE A4
VER A2