

HDMI-19P-SND12x-S297

SHELL PLATED :

Blank	NI
G	GOLD

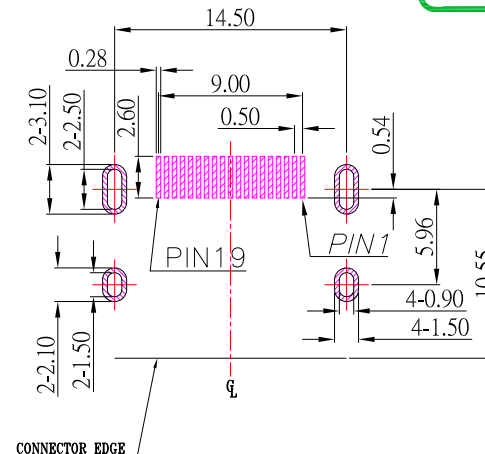

RECOMMENDED P.C.B. LAYOUT

NOTE:

1.MATERIAL:

- 1.1 HOUSING: LCP,UL94V-0 , BLACK
- 1.2 CONTACT: BRASS
- 1.3 SHEEL: BRASS

2.PLATING :

- 2.1 CONTACT: PLATED GOLD IN MATING AREA ;
TIN PLATED ON SOLDER BALLS ;
NICKEL UNDER PLATED OVERALL
- 2.2 SHELL: NICKEL UNDER PLATED SURFACE LAYER

3.ELECTRICAL:

- 3.1 RATING: 40V , 0.5A
- 3.2 INSULATION RESISTANCE: 100MΩ MIN
- 3.3 CONTACT RESISTANCE: 30 mΩ MAX
- 3.4 WITHSTANDING VOLTAGE: 500V AC / MINUTE
- 3.5 OPERATING TEMPERATURE: -25°C~ 85°C

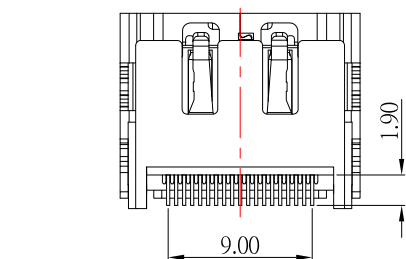
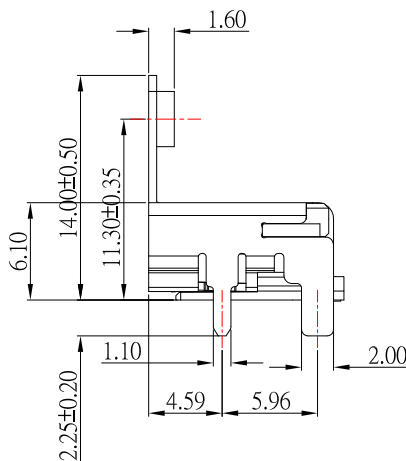
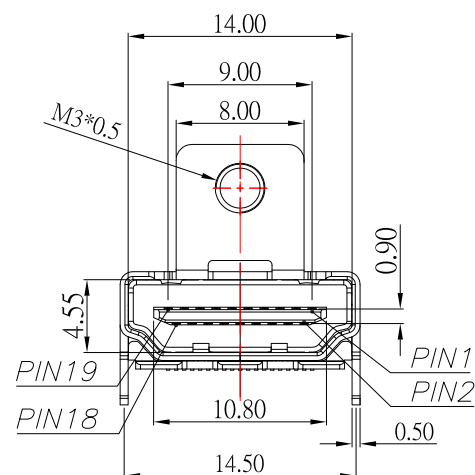

1	更新圖面	Jack	052020
ITEM NO.	DESCRIPTION	DRAWN	DATE

CONTACT 建倚科技股份有限公司
CONTACT TECHNOLOGY CORP.

TOLERANCE UNLESS OTHERWISE STATED :
 Up to 5 ±0.2
 Above 5 ~ 15 ±0.3
 Above 15 ~ 30 ±0.4
 Above 30 ~ 50 ±0.5
 Angle ±0.3

3RD. ANGEL'S



UNITS MM

DRAWN BY:	DATE	MAT'L	TITLE	CONNECTOR
Jack Lu	05/20/20			
CHECKED BY:	DATE	FINISH	MODLE	HDMI AF SMT 單耳無柱,螺絲孔 H11.28mm
Jacky Chen	05/20/20			
APPROVED BY:	DATE	SCALE	DWG NO.	HDMI-19P-SND12x-S297
Tony Kao	05/20/20	1 : 1	PART NO.	HDMI-19P-SND12x-S297
		SHEET NO.	1 of 1	SIZE A4
				VER R1