

P.C.B LAYOUT  
TOP VIEW

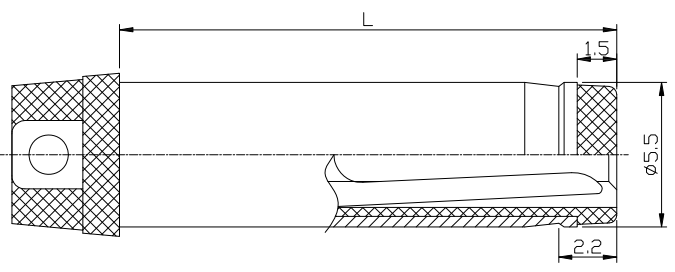

RECOMMENDED PLUG

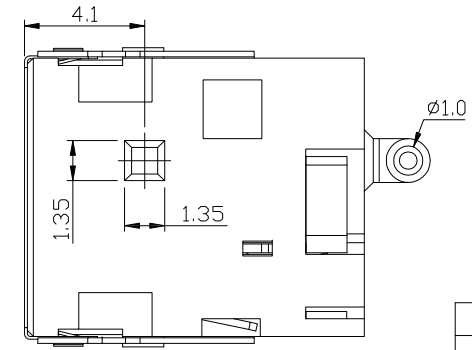

MODEL NO.	DC-083HS-2.5
SCHEMATIC	

SPECIFICATION

1. Rating : DC 30V, 8.0A
2. Contact resistance :  $\leq 30m\Omega$
3. Insulation resistance :  $\geq 100M\Omega$
4. Withstand voltage : 500VAC
5. Insertion and extraction force : 5-25N
6. life test : 5,000 cycles

NO.	DESCRIPTION	QTY	MATERIAL	PLATING
7	COVER	1	SUS	
6	COAT	1	PHOSPHOR BRONZE	Ni-Plating
5	PIN	1	ZINC ALLOY	Ni-Plating
4	STOPPER	1	SUS	
3	CURVE PIECE	1	BRASS	Sn-Plating
2	SPRING PIECE	1	SUS	Sn-Plating
1	HOUSING	1	LCP	

**CONTACT** 建倚科技股份有限公司  
CONTACT TECHNOLOGY CORP.

TOLERANCE UNLESS OTHERWISE STATED :  
 Up to 5 ±0.2  
 Above 5 ~ 15 ±0.3  
 Above 15 ~ 30 ±0.4  
 Above 30 ~ 50 ±0.5  
 Angle ±0.3

3RD. ANGEL'S UNITS MM

DRAWN BY:	DATE	MAT'L	TITLE	JACK
Jack Lu	01/08/21		MODLE	DC JACK
CHECKED BY:	DATE	SCALE	DWG NO.	DC-083HS-2.5-S124
Jacky Chen	01/08/21	1 : 1	PART NO.	DC-083HS-2.5-S124
APPROVED BY:	DATE	SHEET NO.	SIZE	A4
Tony Kao	01/08/21	1 of 1	VER	R

ITEM NO.	DESCRIPTION	DRAWN	DATE