

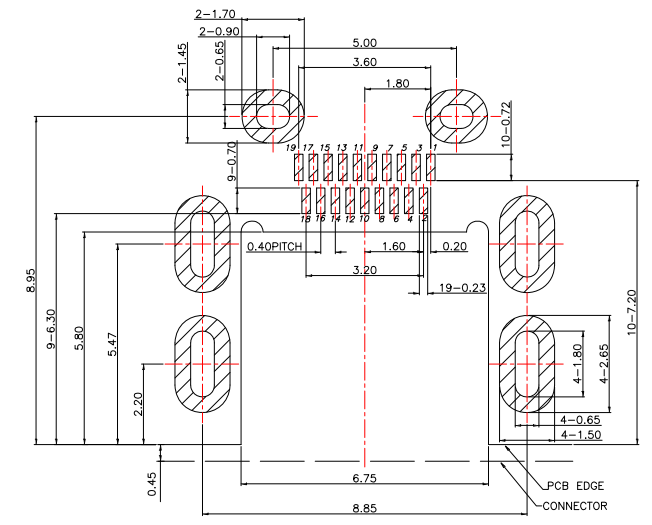

HDMI-D-19M1-x-S273

鍍層厚度：
Blank : 1u"
2 : 15u"
3 : 30u"

DATE CODE
XXX
WEEK OF YEAR
LAST ONE
DIGIT OF YEAR

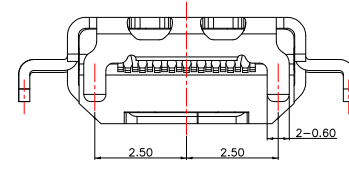
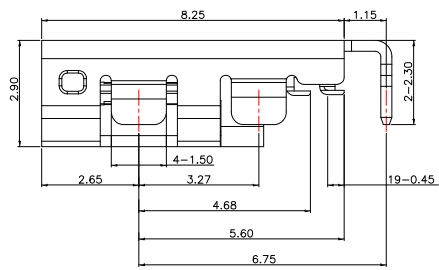
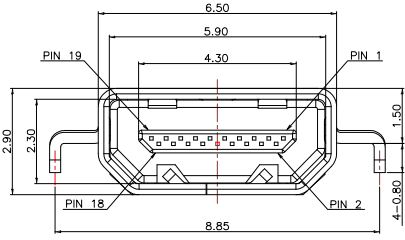
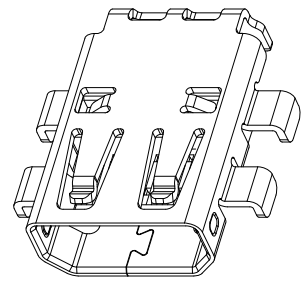
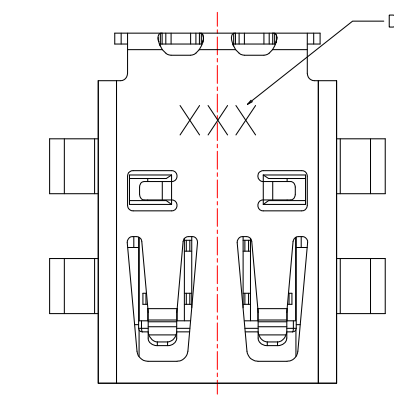

RECOMMENDED PCB LAYOUT(TOP VIEW)

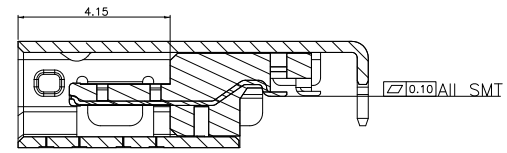
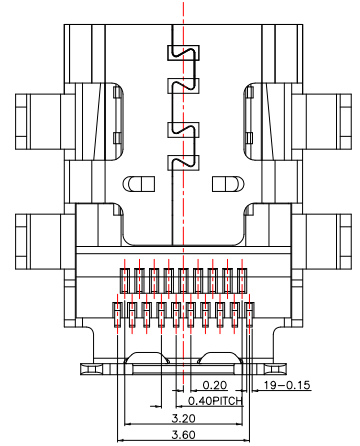

SECTION A-A

Material:

- 1.Housing: High Temperature Thermal Plastics,UL 94V-0
- 2.Contact: Phosphor Bronze
- 3.Shell: Stainless Steel

Finish:

- 1.Contact: Plated Gold in Mating Area ;
Gold Plated on Solder Balls ;
Nickel under plated overall
- 2.Shell: Nickel under Plated surface layer

CONTACT 建倚科技股份有限公司
CONTACT TECHNOLOGY CORP.

TOLERANCE UNLESS OTHERWISE STATED :
Up to 5 ±0.2
Above 5 ~ 15 ±0.3
Above 15 ~ 30 ±0.4
Above 30 ~ 50 ±0.5
Angle ±0.3

3RD. ANGEL'S

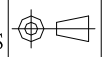

UNITS MM

DRAWN BY:	DATE	MAT'L	TITLE	CONNECTOR
Jack Lu	03/11/14		MODLE	HDMI DTYPE 沉板, 外殼鍍銀
CHECKED BY:	DATE	SCALE	DWG NO.	HDMI-D-19M1-x-S273
Jacky Chen	03/11/14	1 : 1	PART NO.	HDMI-D-19M1-x-S273
APPROVED BY:	DATE	SHEET NO.		SIZE
Tony Kao	03/11/14	1 of 1		A4
				VER
				R2

ITEM NO.	DESCRIPTION	DRAWN	DATE
2	更新料號	Jack	031114
1	新增PCB-pin標號	Jack	012414