

RECOMMENDED PCB LAYOUT (TOP VIEW)

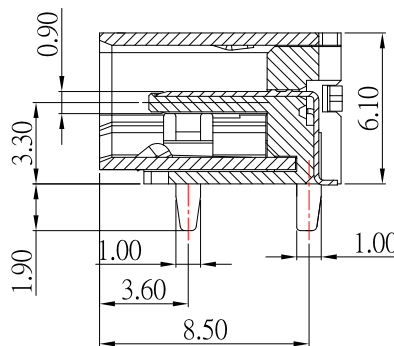
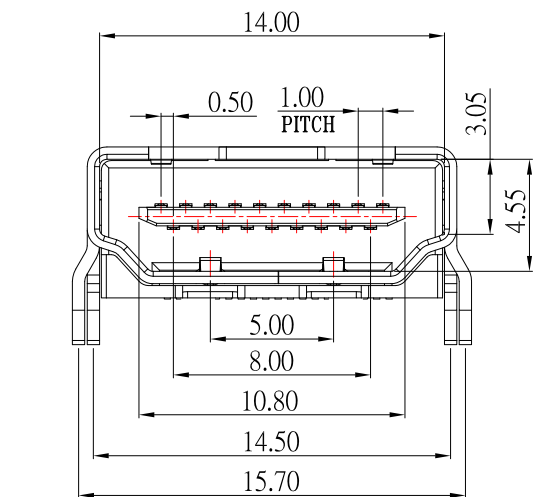

NOTE:

1.MATERIAL:

1.1 HOUSING: LCP, UL94V-0,Black

1.2 CONTACT: BRASS

1.3 SHELL: BRASS

2.PLATING :

2.1 CONTACT: PLATED GOLD IN MATING AREA ;

TIN PLATED ON SOLDER BALLS ;

NICKEL UNDER PLATED OVERALL

2.2 SHELL: NICKEL UNDER PLATED SURFACE LAYER

3.ELECTRICAL:

3.1 RATING CURRENT: 1.5A

3.2 RATING VOLTAGE: 40V DC

3.3 CONTACT RESISTANCE: 30 mΩ Max

3.4 INSULATION RESISTANCE: 1000MΩ Min

3.5 WITHSTANDING VOLTAGE: 500V DC / minute

1	更新料號	Jack	021115
ITEM NO.	DESCRIPTION	DRAWN	DATE

**CONTACT** 建倚科技股份有限公司  
CONTACT TECHNOLOGY CORP.

TOLERANCE UNLESS OTHERWISE STATED :  
 Up to 5 ±0.2  
 Above 5 ~ 15 ±0.3  
 Above 15 ~ 30 ±0.4  
 Above 30 ~ 50 ±0.5  
 Angle ±0.3

3RD. ANGEL'S



UNITS MM

DRAWN BY:	DATE	MAT'L	TITLE	CONNECTOR
Jack Lu	02/11/15			
CHECKED BY:	DATE	FINISH	MODLE	HDMI A/F 短體無耳無柱 SMT
Jacky Chen	02/11/15			
APPROVED BY:	DATE	SCALE	DWG NO.	HDMI-19P-SND5-S277
Tony Kao	02/11/15	1 : 1	PART NO.	HDMI-19P-SND5-S277
		SHEET NO.	1 of 1	
				SIZE A4
				VER R1