



HDMI-19P-SNDx-S183

SHELL MATERIAL:

Blank	Phosphor Bronze
I	SPCC

RECOMMENDED P.C.B. LAYOUT

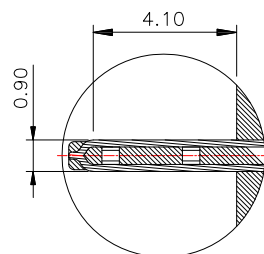
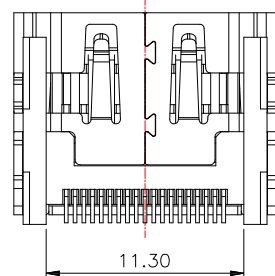
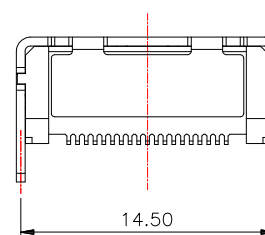
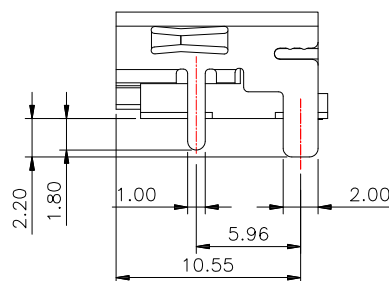
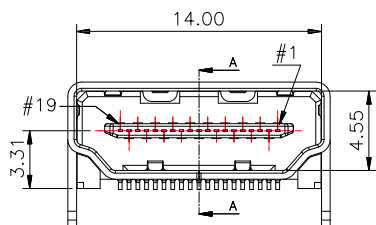
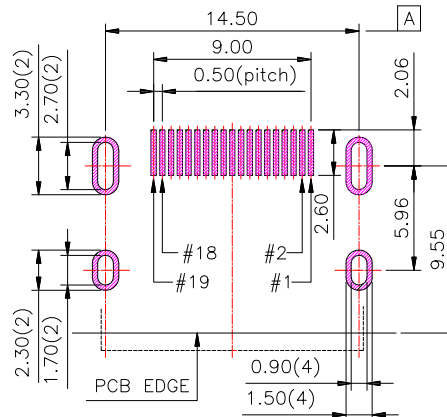
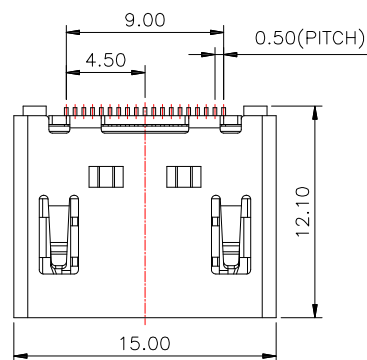

SECTION A-A
SCALE 2/1

NOTE:

1.MATERIAL:

- 1.1 HOUSING: SYNTHETIC RESIN , BLACK
- 1.2 CONTACT: PHOSPHOR BRONZE
- 1.3 SHEEL: PHOSPHOR BRONZE / SPCC

2.PLATING :

- 2.1 CONTACT: PLATED GOLD IN MATING AREA ;
TIN PLATED ON SOLDER BALLS ;
NICKEL UNDER PLATED OVERALL

- 2.2 SHELL: NICKEL UNDER PLATED SURFACE LAYER

3.ELECTRICAL:

- 3.1 CURRENT RATING: 0.5A
- 3.2 INSULATION RESISTANCE: 100MΩ MIN
- 3.3 CONTACT RESISTANCE: 60 mΩ MAX
- 3.4 WITHSTANDING VOLTAGE: 500V AC / MINUTE
- 3.5 OPERATING TEMPERATURE: -10°C~ 60°C

4.MECHANICAL:

- 4.1 INSERTION FORCE: 44.1 N MAX
- 4.2 WITHDRAWAL FORCE: 9.8 ~ 39.2 N

CONTACT 建倚科技股份有限公司
CONTACT TECHNOLOGY CORP.

TOLERANCE UNLESS OTHERWISE STATED :
Up to 5 ±0.2
Above 5 ~ 15 ±0.3
Above 15 ~ 30 ±0.4
Above 30 ~ 50 ±0.5
Angle ±0.3

3RD. ANGEL'S



UNITS MM

DRAWN BY: Jack Lu
CHECKED BY: Jacky Chen
APPROVED BY: Tony Kao

DATE: 08/26/15
DATE: 08/26/15
DATE: 08/26/15

MAT'L		TITLE	CONNECTOR
FINISH		MODLE	HDMI A/F SMT
SCALE	1 : 1	DWG NO.	HDMI-19P-SNDx-S183
SHEET NO.	1 of 1	PART NO.	HDMI-19P-SNDx-S183

SIZE A4
VER R

ITEM NO.	DESCRIPTION	DRAWN	DATE